

**CITY OF EUSTIS
TREE REMOVAL APPLICATION/PERMIT**

Applicant: _____ Date _____

Address: _____

Telephone #: _____ E-mail address _____

Address of tree(s) to be removed: _____

Property Size: _____

Note: If applicant is not the owner of the property, a letter of permission must be provided.

PROPOSED DEVELOPMENT ACTIVITY:

- _____ Existing Residential/Commercial Site
- _____ New Residential/Commercial Building Permit
- _____ Initial Site/Subdivision Plan
- _____ Other _____

REASON FOR REMOVAL:

- _____ Street opening.
- _____ Utilities and draining.
- _____ Property access.
- _____ Property use.
- _____ Hazard.
- _____ Poor tree health.
- _____ Thinning of trees.

Please check one or more of the above conditions that pertain to the property, and provide documentation of the condition (for example, poor tree health. Provide pictures of tree if declining health is evident, or a letter from a certified arborist if not): _____

Provide a tree inventory indicating location, size (DBH), and species of trees to be removed and preserved.

Existing Single Family applicants can use the back of this form to draw a sketch of the subject property or attach a copy of the property survey. Sketches must include the following: 1) Property boundaries and surrounding roads; 2) a North arrow; 3) all existing structures on the property; 4) small circles depicting all trees on the property with an X through the ones to be removed; 4) include the species and the size (DBH) of each tree.

Permit remains in effect for 3 months only.

Applicant signature _____ Date _____

To be completed by staff

GRANTED _____ permit # _____

Replacement requirements: _____

DENIED _____ Reason: _____

Conditions:

- 1. Site Visit Made Yes _____, Date _____ No _____
- 2. Post Permit _____
- 3. Remove All Debris _____
- 4. Replacement completed _____
- 5. Other: _____

Authorizing Signature

Date

TREE PROTECTION IN THE CITY OF EUSTIS

The City of Eustis has established "rules and regulations governing the protection of trees and vegetative cover as a valuable community resource within the city.... Tree protection is beneficial to the city by improving community appearance and quality of life, enhancing property values, and creating a functional and aesthetically pleasing living environment for existing and future residents." Section 115-8 Land Development Regulations

Section 115-8 of the Eustis Land Development Regulations governs the protection and preservation of trees and vegetation in the city of Eustis. This regulation requires a permit for the removal of most trees with a diameter at breast height (DBH) of 6 inches or greater. (DBH is measured 54 inches above the grade at the base of the tree).

A tree removal permit is not required for trees on the attached list of noxious/exotic species and/or under the following conditions and situations (as determined by the director of development services or designee):

1. Removal of trees for a bona fide agricultural use such as citrus, tree nurseries, forest crops, animal husbandry, and green houses.
2. Removal of dead, diseased, or trees that have fallen from natural causes.
3. Removal of trees that are an eminent danger to public or private property.
4. Removal of trees planted on the premises of a plant nursery or tree farm...
5. Removal of trees within approved utility rights-of-way or easements...
6. Removal or transplanting of trees by public utilities with the power of eminent domain
7. Emergency conditions...

Tree removal permits are issued only if one or more of the following conditions exist:

1. Street opening – tree location restricts road ROW
2. Utilities and drainage – tree location restricts construction of utilities or drainage facilities
3. Property access – tree location restricts vehicular access to property where there is no other reasonable access point
4. Property use – tree location restricts reasonable use of the property consistent with applicable codes and design modifications are not practical or reasonable
5. Hazard – a tree that constitutes a hazard to life or property
6. Poor tree health – tree is dead; lacking functioning vascular tissue; deteriorating beyond practical restoration; or has a disease that could be transmitted to other trees
7. Thinning of trees – trees are so dense that light and air circulation are impaired; removal of up to 25% to alleviate the condition

The removal/ replacement of trees that are 24 inches DBH or greater is strongly discouraged. Healthy, protected trees 24" DBH or higher that are removed with or without a permit are subject to replacement. The tree replacement formula for trees 24" DBH and higher is as follows:

(Removal total) x 2.5 = (Replacement total)

Removal total is the sum of tree diameters of all protected trees removed

Replacement total is the total amount of tree diameter that the property owner must provide to compensate for the removal.

The replacement total can be reduced by 60% if the replacement trees are 4" DBH canopy trees (100 gal. container)

- All replacement trees must be at least 2.5" DBH, 10 ft. tall, and 5 ft. wide at time of planting.
- Approved ornamental and palm trees shall not exceed 25% of the requirements and 50% of the trees shall be live oaks.
- Replacement trees shall be planted on-site, if practical. Otherwise, the property owner shall donate the monetary value of the required trees to the city for the purpose of planting trees on public property.

SAMPLE SKETCH FOR SINGLE FAMILY HOME TREE REMOVAL PERMIT

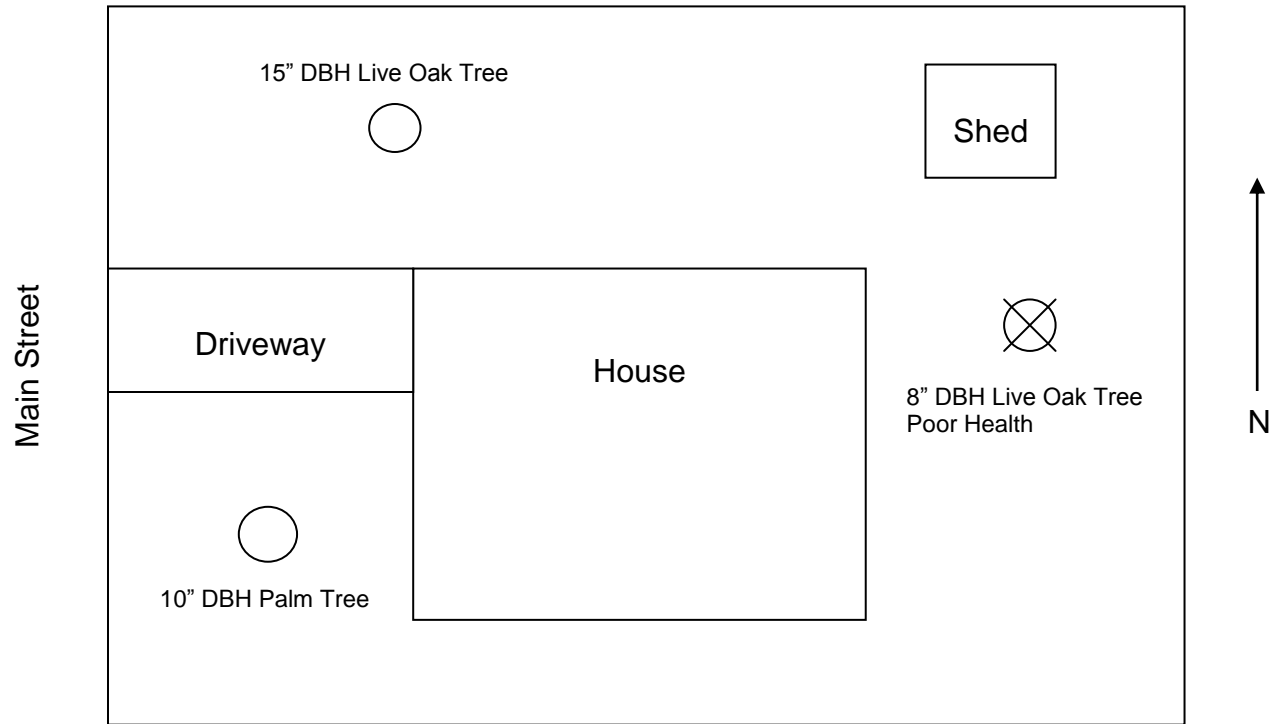

CITY OF EUSTIS LIST OF NOXIOUS/EXOTIC SPECIES

- a. Australian Pine (*Casuarina* spp.).
- b. Melaleuca (*Melaleuca quinquenervia*).
- c. Chinaberry (*Melia azedarach*).
- d. Ear Tree (*Enterlobium cyclocarpum*).
- e. Eucalyptus species (*Eucalyptus* spp.).
- f. Brazilian Pepper (*Schinus terebinthifolius*).
- g. Paper Mulberry (*Broussonetia papyrifera*).
- h. Silk Oak (*Grevillea robusta*).
- i. Empress Tree (*Paulownia tomentosa*).
- j. Tree of Heaven (*Ailanthus altissima*).
- k. Chinese Tallow Tree (*Sapium sebiferum*).
- l. Japanese Tallow Tree (*Sapium japonicum*).
- m. Camphor (*Cinnamomum camphora*).
- n. California Privet (*Ligustrum ovalifolium*).
- o. Cedar Gum (*Eucalyptus gunnii*).